

# Leica DMi1 Set Up

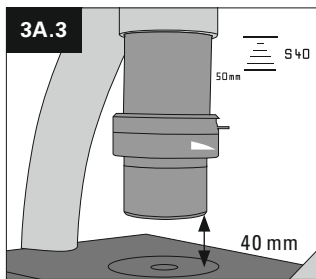

MICROSYSTEMS

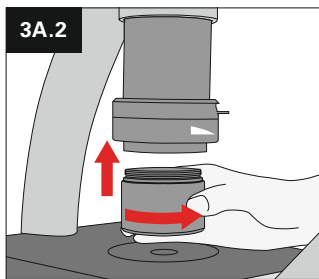
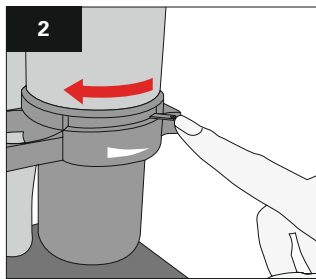
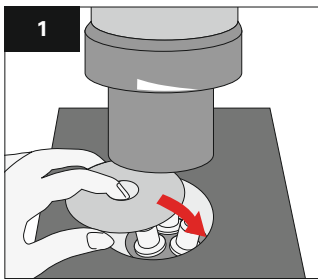

If S40: 3A  
If S80: 3B

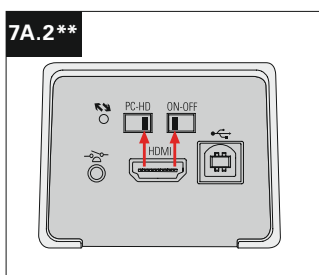
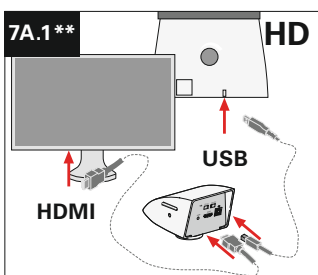
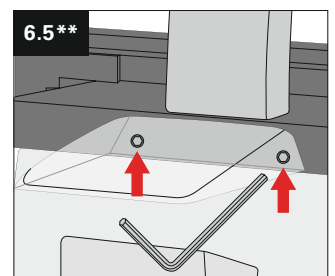
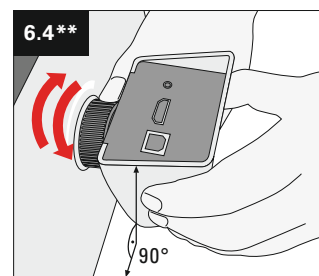
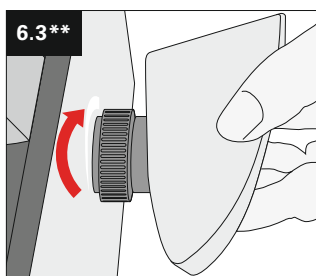
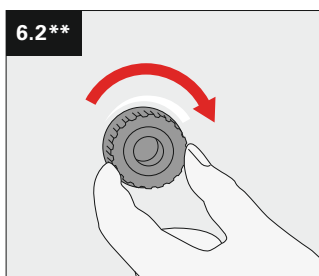
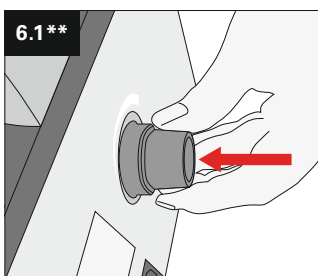
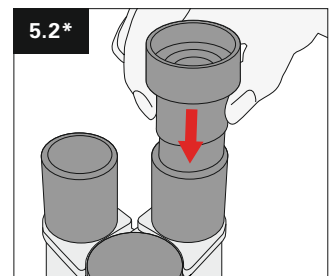
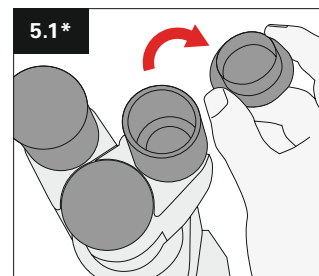
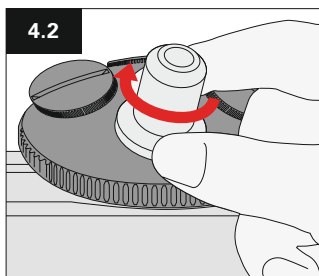
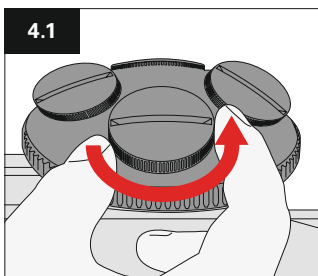
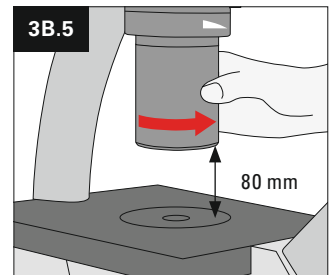
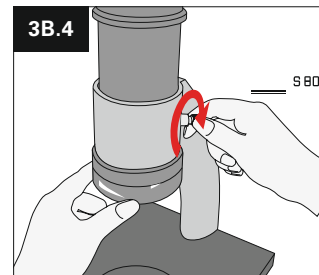
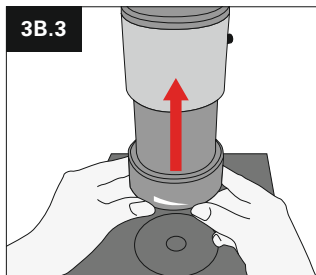
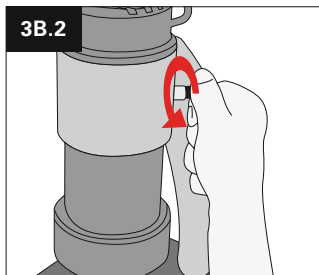
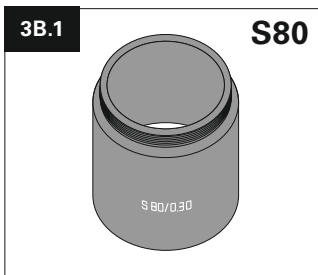

If HD: 7A  
If PC: 7B

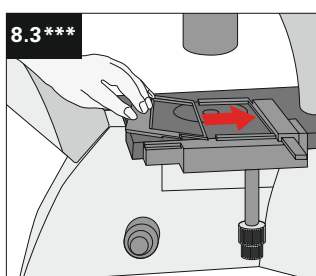
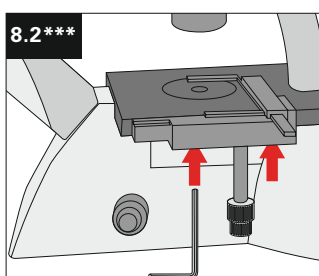
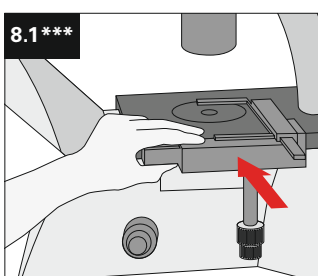
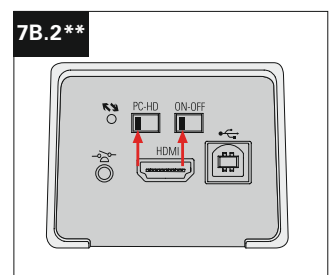
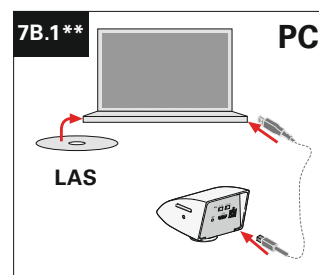

\* DMi1 with exchangeable eyepieces  
\*\* DMi1 with camera  
\*\*\* Optional object guide (accessory)

# Leica DMi1 Start Up



MICROSYSTEMS

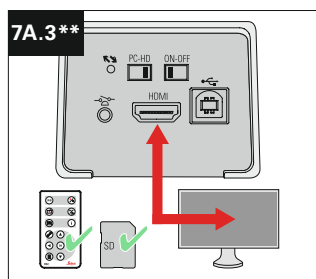
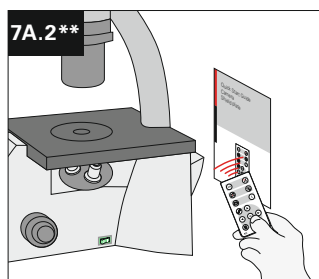
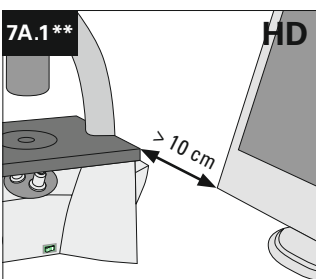
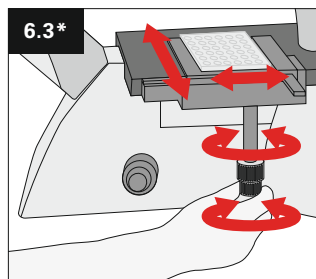
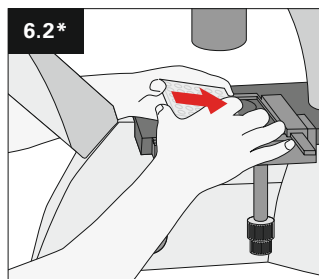
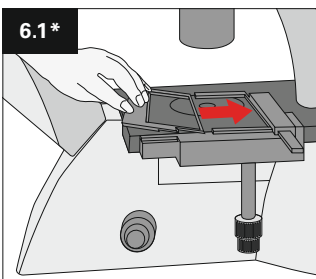
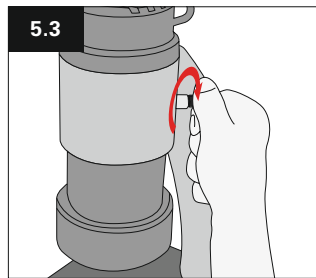
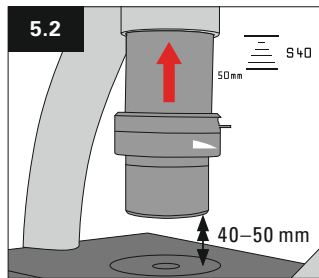
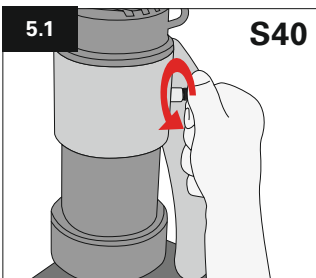
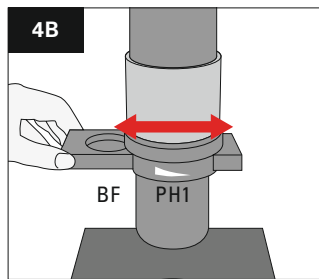
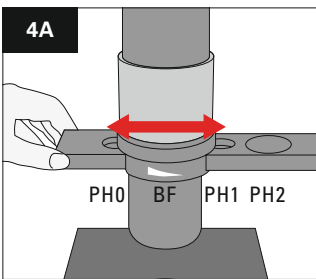
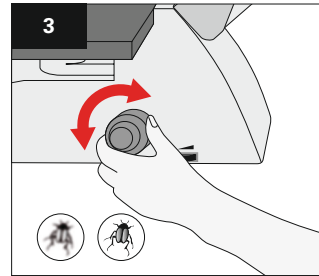
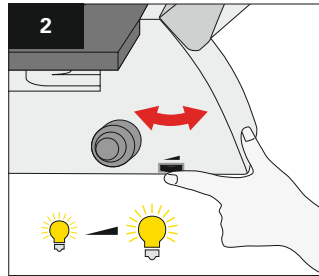
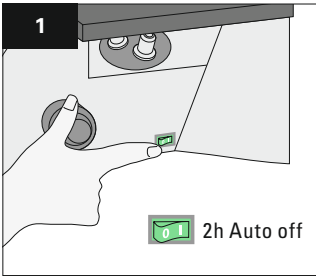

**7A.4\*\***

Set White Balance		Start/Stop Movie Record
Save Image to SD Card		Pause/Play
Show/Hide Gallery		Show/Hide Info-Box
Pairing		▲▼ Next/Previous Overlay
OK: Confirm/Zoom/Start Playback		◀▶ Next/Previous Illumination Mode
Show Menu		

**7A.5\*\***

Main menu	Submenu	
COLOR	RESET CAM	PRESS OK
EXPOSURE	SET DATE/TIME	PRESS OK
RESOLUTION	SHOW DATE/TIME	IMG ONLY
SETUP CAMERA	SET FILENAME	PRESS OK
SETUP USER	SHOW FILENAME	LIVE + IMG
SETUP OVERLAY	FLIP IMAGE	HORZ + VERT
	AUDIO/BEEP	ENABLE

**7A.6\*\***

Main menu	Submenu
COLOR	SET WB ← PRESS OK →
EXPOSURE	WB MODE AUTO
RESOLUTION	RED LEVEL
SETUP CAMERA	BLUE LEVEL
SETUP USER	BLACK LEVEL
SETUP OVERLAY	

**7A.7\*\***

Main menu	Submenu
COLOR	EXP MODE ← AUTO →
EXPOSURE	EXPOSURE
RESOLUTION	GAIN
SETUP CAMERA	BRIGHTNESS
SETUP USER	GAMMA
SETUP OVERLAY	

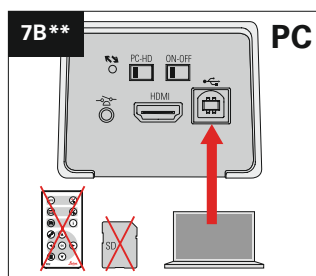

\* Optional object guide (accessory)  
\*\* DMi1 with camera

